

# KAVAATA<sup>®</sup> HYDRAULIC FITTINGS

## MALE STUD COUPLING (BSP)

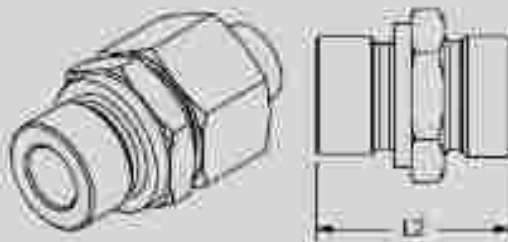
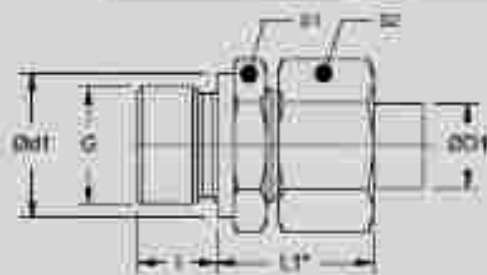

Series	TUBE OD (Dd1)	G Male BSP Thread (G)	L	Dd1	S1	L1*	S2	L2
Light (L) 200 Bar	8	G 1/8"	8	14	14	14	14	25.5
	8	G 1/4"	12	16	18	21	17	26
	8	G 3/8"	12	22	22	26.5	17	30.5
	10	G 1/2"	12	18	18	26.0	18	30
	10	G 3/8"	12	22	22	26	18	31.5
	12	G 1/4"	12	16	18	22	20	31
	12	G 3/8"	12	20	22	27.5	22	31.5
	12	G 1/2"	14	26	27	28	22	34
Heavy (H) 300 Bar	8	G 1/8"	12	18	18	28.5	17	32
	8	G 1/4"	12	16	18	31	18	34
	10	G 3/8"	12	20	22	32	20	34.5
	12	G 3/8"	12	22	22	33.5	24	36.5
	12	G 1/2"	14	28	27	34	24	38

\* DIMENSIONS GIVEN ARE APPROX FIGURES WITH TIGHTENED NUT

**MANUFACTURER'S ADDRESS:**

**RAJEEV & COMPANY**

Head Office : 423, Nazar Camp Cross 3, Main Road, Vadgaon, Belgaum-590005, Karnataka, India

Factory Address : 103/3, Dewarwadi Village, Chandgad Taluk, Kolhapur Dist, Maharashtra - 416507, India

Phone : 0831-2482327 / 2484635 | Mob.: 9243210643 / 9243222573 / 9234220173 | Fax : 0831-2481752

E-mail : [sales@kavaatavalves.com](mailto:sales@kavaatavalves.com)

Website: [www.kavaatavalves.com](http://www.kavaatavalves.com)